

National Development
Newton, MA

ALTA Surveys Waterstone at Wellesley

Project Description

Our experience in Title Insurance Surveys is extensive. Clients include Calare Properties, National Development, Archon Group, as well as many of the leading area law firms such as Goulston & Storrs, Sherin & Lodgen, and Goodwin Proctor.

Our field personnel are very experienced in monument location, which is key to sound property line determination, and are well trained to be highly aware of encroachment issues and prescriptive rights evidence during the course of the survey.

We pride ourselves in our ability and commitment to deliver our ALTA surveys well within the due diligence period.

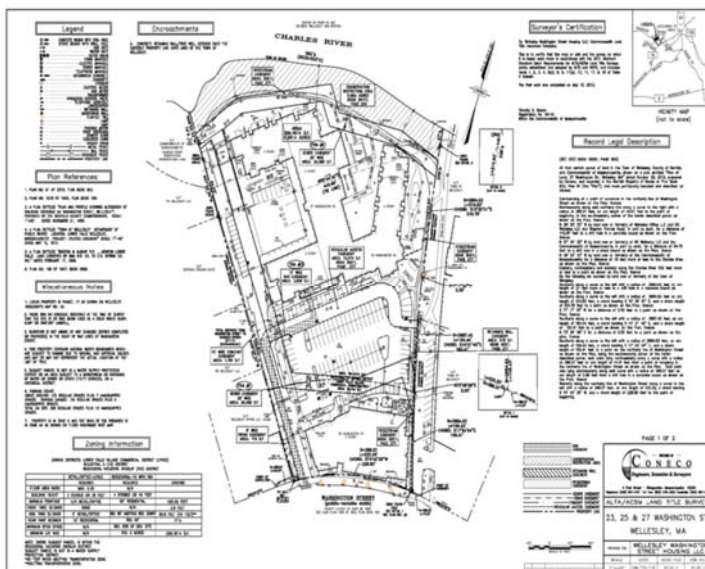

Contact: Timothy S. Bodah, PLS, Principal - Survey
(508) 328-8931 (cell) • tbodah@coneco.com